



RPS 12th Avenue Faridabad | Future Investment

[RPS 12th Avenue Faridabad](https://sagarpropertyess.com/property/rps-wtc-12th-avenue/) offers premium office and retail spaces in Sector 27C, ensuring seamless connectivity to key hubs like NH2, Mohan Co-Operative (5 min walk), Sarai Metro Station (7 min walk) and Faridabad Toll (0km). With modern designs, spacious layouts and advanced facilities, it provides the perfect setting for businesses and retail ventures to thrive in a prime, well-connected location. Visit Us: <https://sagarpropertyess.com/property/rps-wtc-12th-avenue/>



RPS 12th Avenue

<https://sagarpropertyess.com/property/rps-wtc-12th-avenue/>

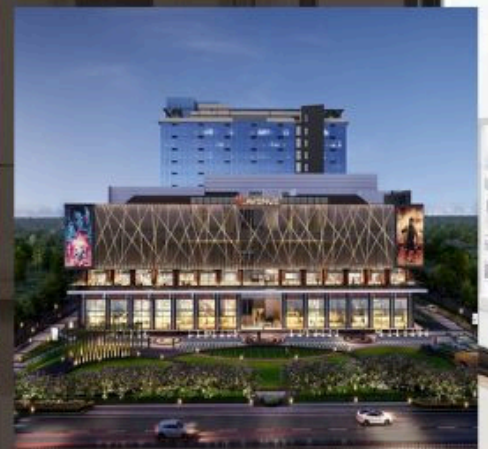

Property Features

- SECURITY OF INVESTMENT
- SECURITY OF INVESTMENT
- PRIDE OF OWNERSHIP